

nuvo

EXIT

INNOVATIVE

IM

MARINE

MODERN REEF READY

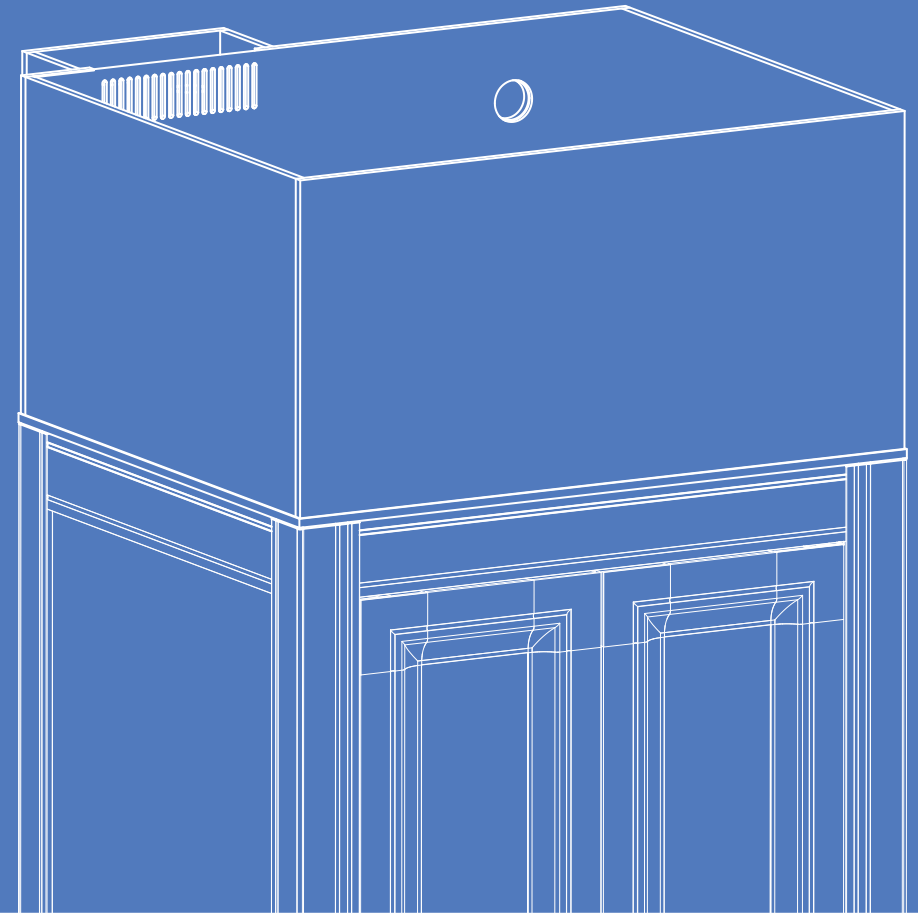

INSTRUCTION MANUAL

EXT-25 | EXT-30L | EXT-40 | EXT-50

LIMITED WARRANTY

The NUVO INT has a 1 YEAR limited warranty. The NUVO INT is warranted to the original purchaser against defective material and workmanship for 1 YEAR from the date of original purchase. This warranty is valid only under the following conditions: additions, modifications, or changes made to the product by the purchaser and not by the manufacturer shall void this warranty. Damages brought on by abuse, misapplication, or mishandling also voids this warranty.

This warranty is limited to the repair or replacement of the product at the discretion of the manufacturer. This warranty does not cover personal injury, property loss, including livestock or damage (direct, incidental, or consequential) arising out of use of this product. This warranty gives you specific rights and you may also have other rights, which may vary from state to state.

The Product Registration Card must be filled out completely and returned within (14) days from the date of purchase. Failure to do so will void this warranty. A proof of purchase from an authorized dealer must be provided when making a warranty claim.

For Warranty Claims please contact our Customer Care Department. 866-368-7941 | warranty@innovative-marine.com

An RMA# must be issued before sending any product back to Innovative Marine. Products sent back to Innovative Marine without an RMA# will not be accepted. Service on products will not extend the original warranty period.

Email: warranty@innovative-marine.com

PLACING AND LEVELING YOUR NUVO AQUARIUM

Make sure your NUVO is set on a level surface to prevent undue stress on the aquarium tank from stress and leaks.

It is not recommended that this aquarium is set upon coffee tables, end tables, TV stands, or night stands unless the structure has been properly tested to withstand the weight limits of the aquarium.

Please pay special attention when leveling your aquarium on carpet.

Before lifting your aquarium, make sure your stand is in position.

Lifting the glass aquarium onto its stand will require more than two people. Please use proper lifting techniques when lifting large heavy objects.

Lift from the bottom of the aquarium DO NOT lift using the aquarium's edges this will cause stress on the glass and seals and may cause leakage.

The back of the aquarium should be flush with your stand and all four corners are not overhanging the edges.

Once you have placed your aquarium atop your stand, make sure your stand has not moved from its position.

Place a level on edge of tank, if necessary readjust and reposition tank and stand.

AQUARIUM

- + High Clarity Low Iron Glass
- + Laser Cut Black Acrylic Weir
- + Black Silicone
- + Rubber Leveling Mat
- + Pre-drilled 3/4" Bulkhead Return Hole

EXTERNAL LOW IRON GLASS OVERFLOW

- + DIMS: 7.9" x 3.5" x 5.9"
- + Solid Glass Construction
- + Pre-drilled 2 - 1" Drain Holes
- + Silent and Safe Herbie Style

Key Terms

BH - Bulkhead	ID - Inner Diameter
S - Slip	OD - Outer Diameter
T - Threaded	

Items Included:

- 2 - 1" Slip x Slip BulkHead [Overflow]
- 1 - 3/4" Threaded x Slip BulkHead [Return]
- 1 - 1" Diameter E-Drain Pipe [Overflow]
- 1 - 3/4" LOC-LINE w/ Flare Nozzle [Return]

1	1" Bulkhead SxS	000030
2	3/4" Bulkhead TxS	000031
3	1" Diameter E-Drain Pipe	000032
4	3/4" LOC-LINE w/ Nozzle	000033

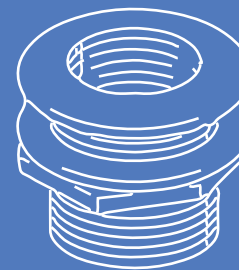

1

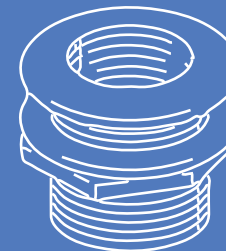

2



3

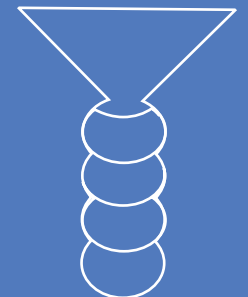

4

MODERN REEF READY

EXTERNAL OVERFLOW BOX [REAR VIEW]

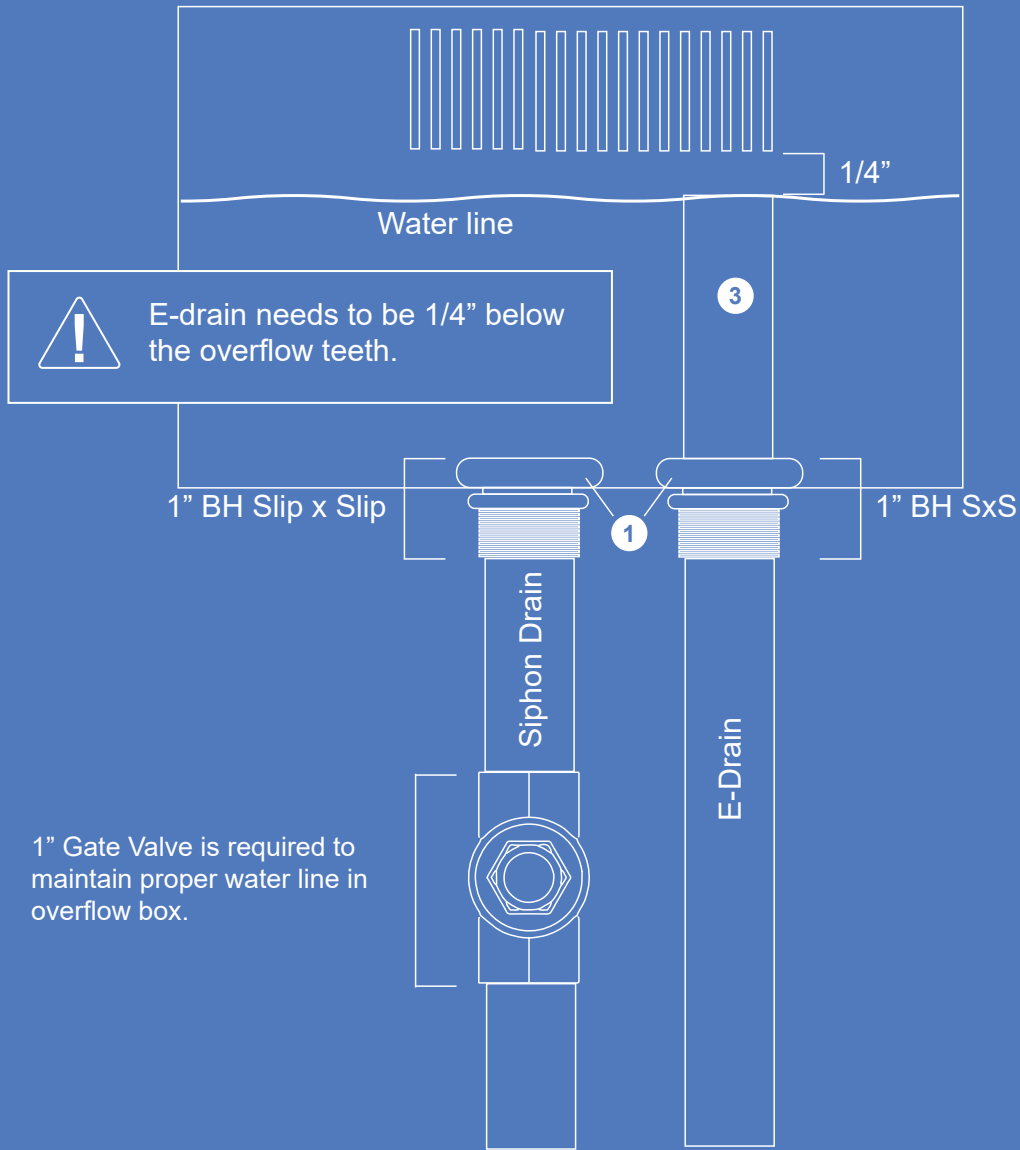

1" Gate Valve is required to maintain proper water line in overflow box.

! NOTE: Siphon Drain Pipe must be submerged a minimum of 1" for drain pipe to siphon properly.

