

ReefRun® DC Pump

User Manual

ENG



 Red Sea

ReefRun® DC Pump

Silent - Smart - Powerful

User Manual

 **Red Sea**

Contents

Introduction.....6

Safety7

Data Sheet.....8

ReefRun Components.....9

Installation & Operation10

Connecting to the ReefRun Dual Controller.....12

Pump Maintenance.....13

Warranty.....14

Introduction

Congratulations on your purchase of Red Sea's ReefRun® DC Pump.

This manual covers the physical installation and maintenance of the ReefRun pumps.

The ReefRun pumps can only be used when connected to a ReefRun Dual controller that provides control of up to 2 ReefRun compatible DC return pumps, DC skimmer or a combination of both. Read the manual provided with the ReefRun Dual controller for full installation and operation instructions for the controller.

The ReefRun Dual Controller is part of Red Sea's suite of smart devices that are operated via Wi-Fi by Red Sea's ReefBeat® App, which needs to be installed on a smart mobile device with internet connectivity.

Welcome to Red Sea's smart reef-keeping.

Sincerely,

The Red Sea Team

Safety

PLEASE READ AND FOLLOW ALL SAFETY INSTRUCTIONS

THIS DEVICE IS INTENDED FOR INDOOR USE ONLY.

DANGER: To avoid possible electric shock, special care should be taken when handling a wet aquarium. For each of the following situations, do not attempt repairs yourself; return the appliance to an authorized service facility for service or discard the appliance.

WARNING: To guard against injury, basic safety precautions should be observed, including the following:

Do not operate any appliance if it has a damaged cord or plug, if it is malfunctioning, or if it is dropped or damaged in any manner.

This appliance can be used by children aged from 8 years and above and persons with

reduced physical, sensory, or mental capabilities or lack of experience and knowledge if they

have been given supervision or instruction concerning use of the appliance in a safe way and

understand the hazards involved. Children shall not play with the appliance. Cleaning and user maintenance shall not be made by children without supervision.

The appliance is only to be used with the power supply unit

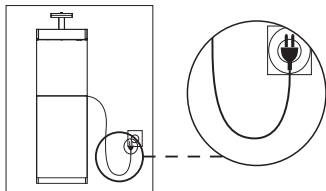

Figure 1: Drip Loop

provided with the appliance.

Close supervision is necessary when any appliance is used by or near children.

To avoid injury, do not contact moving parts.

Always unplug an appliance from an outlet when not in use, before putting on or taking off parts, and before cleaning. Never pull the cord itself to remove the plug from the outlet. Grasp the plug and pull to disconnect.

Do not use an appliance for anything other than its intended use. The use of attachments not recommended or sold by the appliance manufacturer may cause unsafe conditions.

Do not install or store the appliance where it will be exposed to the weather or to temperatures below freezing point.

Make sure an appliance is securely installed before operating it.

Read and observe all the important notices on the appliance.

Note: A cord rated for less amperes or watts than the appliance rating may overheat. Care should be taken to arrange the cord so that it cannot be tripped over or pulled accidentally.

Do not use if cord is damaged. In case of need, do not attempt to replace or repair yourself; return the appliance to an authorized service facility for service or discard the appliance.

In case of need, do not attempt to replace yourself; return the appliance to an authorized service facility for service or discard the appliance.

Data Sheet

	ReefRun 5500	ReefRun 7000	ReefRun 9000
Q min - MAX	2000-5500 l/h 530 - 1450 US gph	3000-7000 l/h 800 - 1900 US gph	4000-9000 l/h 1000 - 2500 US gph
H min - MAX	1.0-3.5 m 3.5-11.5 ft	2.0-5.0 m 6.5-16.5 ft	2.6-7.0 m 8.5-23.0 ft
WATT	10 - 40 W	20 - 65 W	30 - 95 W

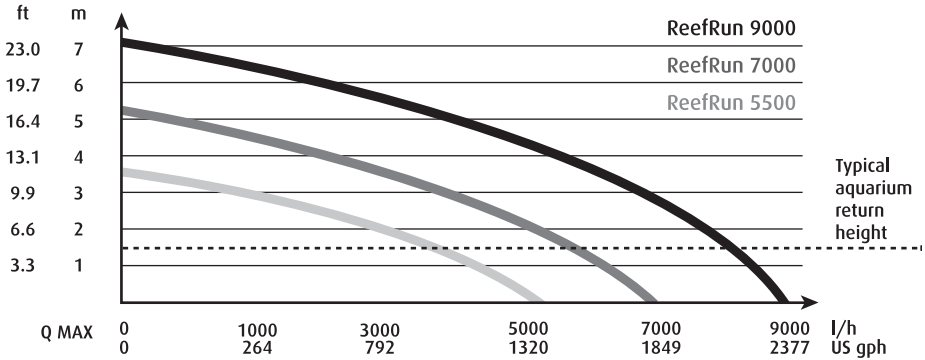

ReefRun Components

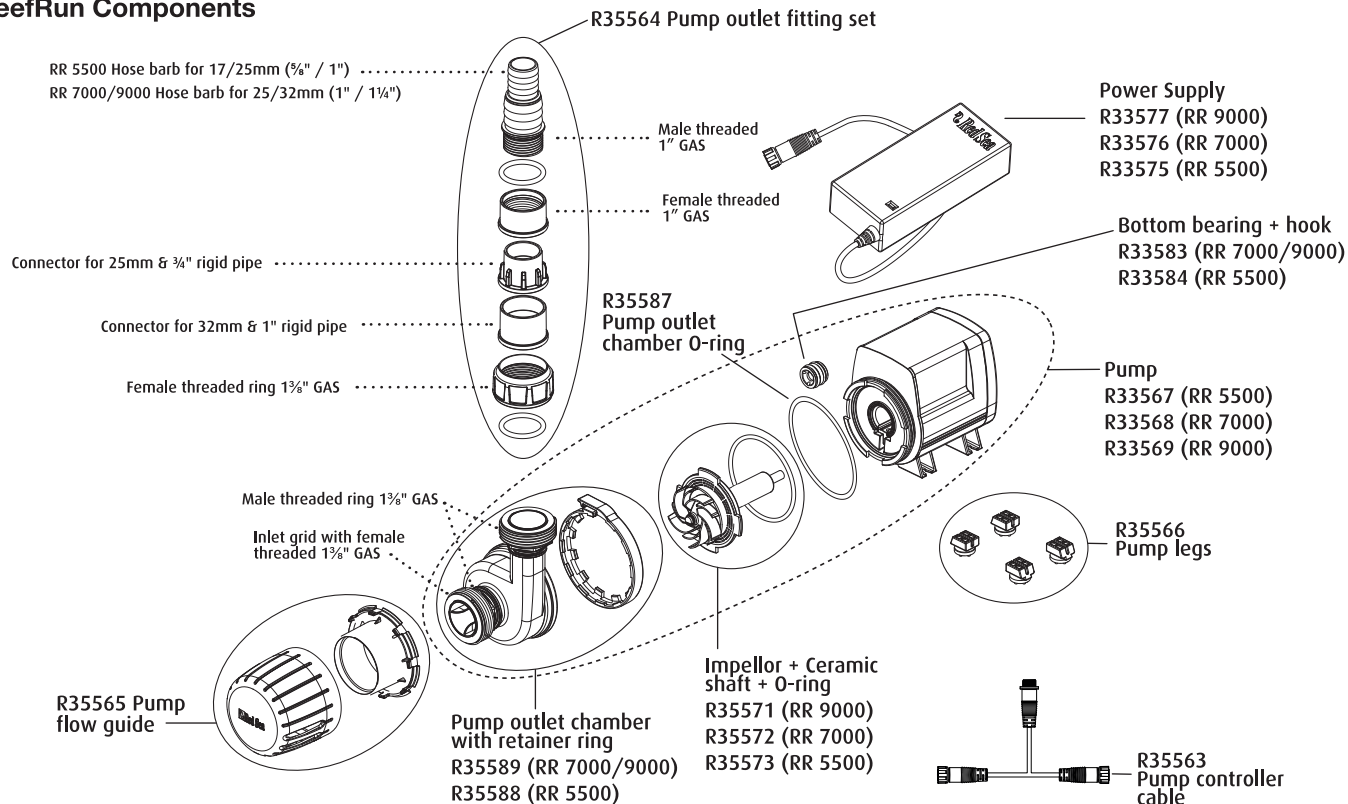

Installation & Operation

Before installing the pump, disassemble and reassemble to familiarize yourself with the component parts.

Select the appropriate place for locating the pump inside your sump taking care to observe the positioning guidelines shown below.

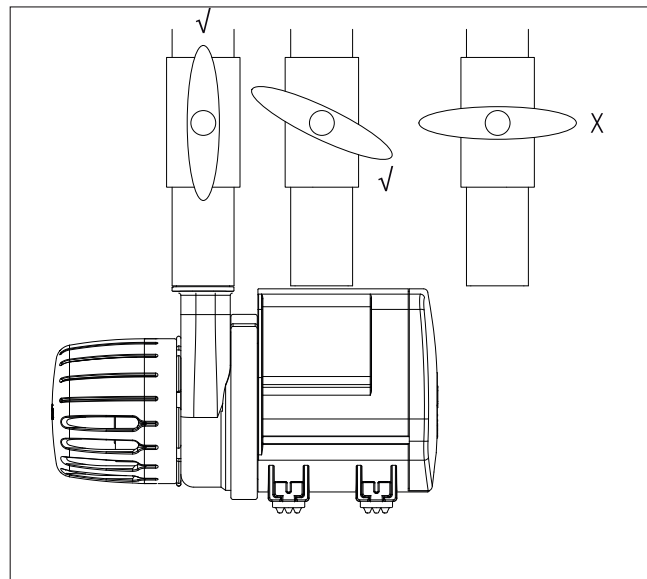
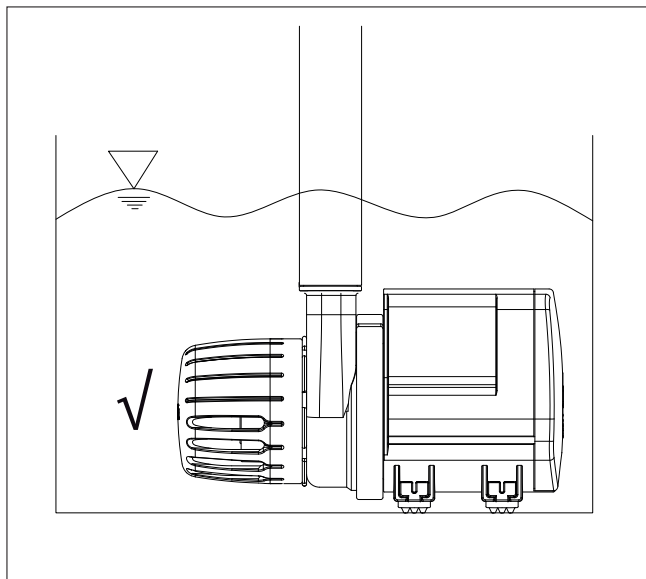

Assemble the 4 rubber feet to the bottom of the pump.

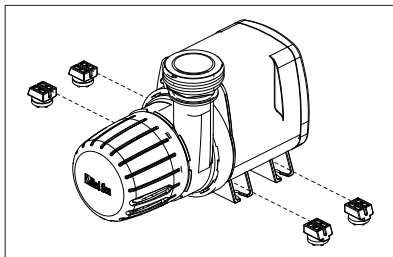

Rotate the flow guide so that the water inlets are facing the bottom of the sump.

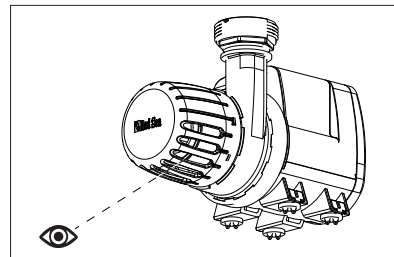

Rotate the pump outlet chamber to provide the best direction for connecting the outlet of the pump to the inlet of the aquarium. Thread the pump cable such that the cable connector is in a convenient place for disconnect / reconnect when doing pump maintenance.

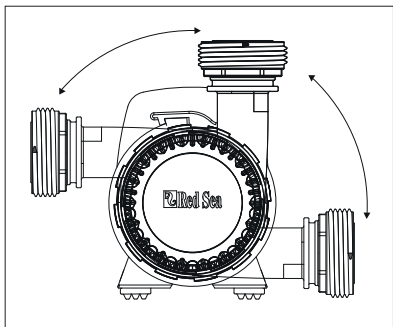

Select and assemble the appropriate hard pipe or flexible tube connectors to the outlet of the pump.

If you are using flexible tubing, make sure that it is securely fastened to the hose barbs with suitable hose clips (not supplied).

Note: The ReefRun pumps are supplied with fittings for installing it fully submerged inside a sump. If you are planning on installing the pump outside the sump you will need to purchase additional fittings from your Red Sea dealer.

Read the ReefRun dual controller instructions before operating the pump.

The pump has built in safety features to prevent damage to the pump in the cases where the pump is not in the water or the impellor cannot rotate. The ReefRun dual controller automatically shuts the pump down and enables the pump to be restarted from the controller/App once the issue has been resolved. After multiple unsuccessful restarts the pump may need to be disconnected from the controller cable for about 30 seconds before it can be restarted.

Connecting to the ReefRun Dual Controller

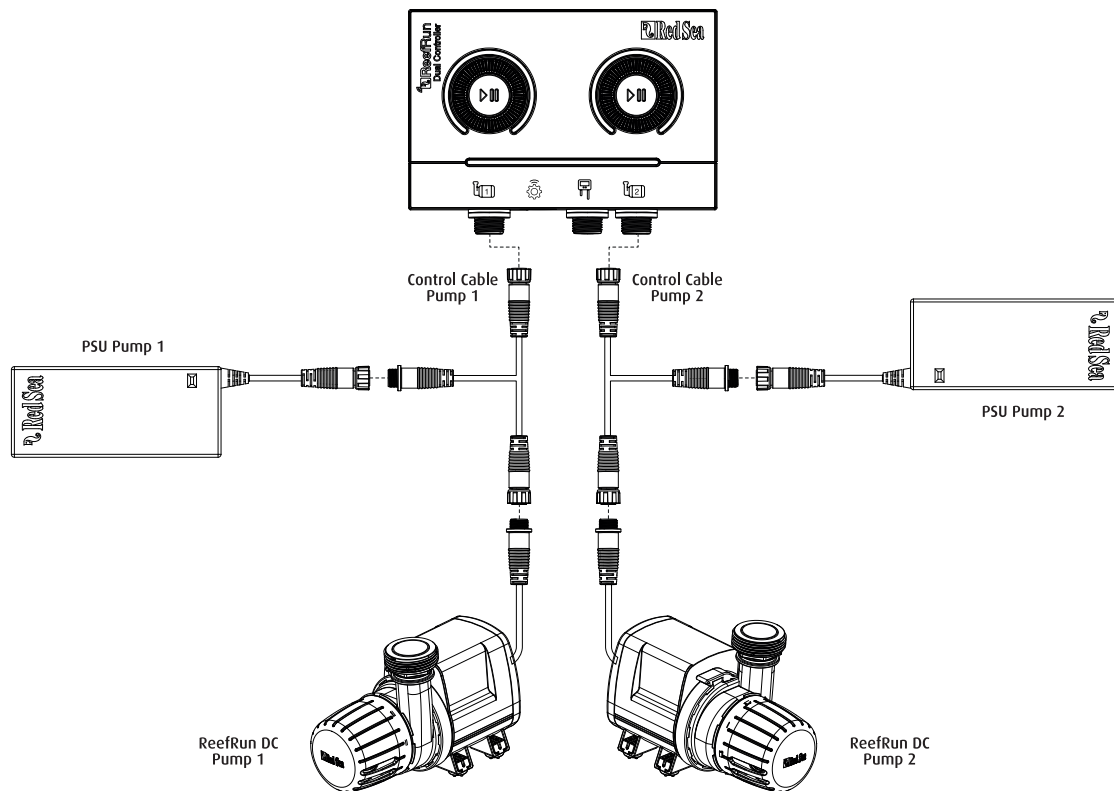

Pump Maintenance

For continued smooth running of the ReefRun pumps we recommended cleaning the pump on a regular basis to remove organic and calcium carbonate deposits.

Before undertaking maintenance, switch the pump off from the controller or App and disconnect the pump from the controller cable. Ensure that the Cable Connector does not fall into the sump.

Remove the pump outlet chamber retainer ring by pulling the tab outwards.

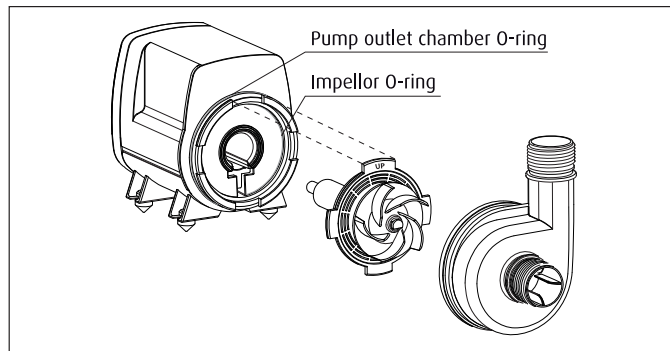
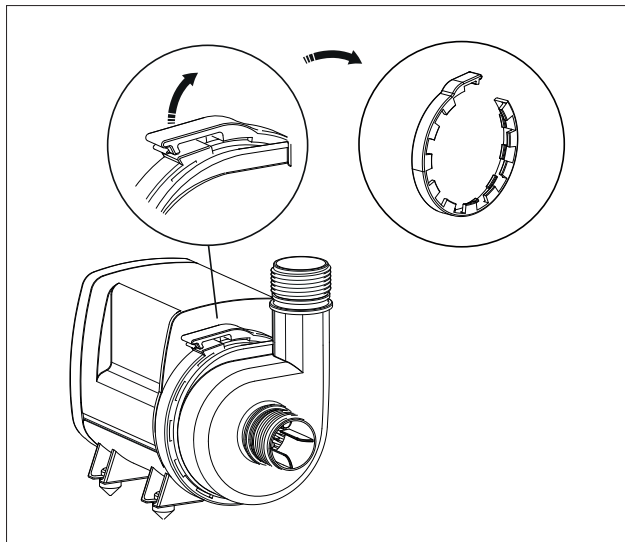

Remove the chamber from the body by rotating and pulling it away from the pump body.

Pull the complete impellor assembly completely out of the body. Pay attention to the O-ring that sits between the impellor assembly and the body (Impellor O-ring).

Rinse the impellor assembly and the pump body with water and use a soft brush to remove deposits. If necessary, soak the impellor assembly and the pump in a slightly acidic solution (such as diluted vinegar). Remove all rubber parts such as O-rings and feet before soaking.

When reassembling the pump pay attention to the following:

The impellor O-ring is in place.

The "UP" on the impellor assembly is at the top of the pump.

NOTE: the impellor shaft has a very strong magnet. Hold the impellor firmly when lowering the impellor shaft into the chamber. Care must be taken not to damage the ceramic bearing at the bottom of the impellor chamber.

The lower bearing and the tool to remove it are available as a spare part.

Warranty

Red Sea Products Limited Warranty.

Thank you for purchasing a Red Sea ReefRun DC-Pumps (hereinafter “the Product”).

Red Sea Aquatics (UK) Ltd. (hereinafter “Red Sea”) warrants the ReefRun DC-pump motors against manufacturer’s defects in material and workmanship for 5 years from your date of purchase.

ReefRun DC-pump impellers are a wear item and as such Red Sea warrants the ReefRun DC-pump impellers against manufacturer’s defects in material and workmanship for 6 months from your date of purchase.

The warranty provided by Red Sea is NOT TRANSFERABLE AND IS LIMITED TO THE ORIGINAL PURCHASER. If the Product is eligible under this warranty, Red Sea will either repair the Product free of charge (not including shipping costs) with new or refurbished parts or replace the Product with a new or refurbished Product at Red Sea’s sole discretion.

This warranty DOES NOT COVER normal wear and tear. It also DOES NOT COVER damage which occurs in shipment and/or failures or defects resulting from use outside the normal, and/or natural disasters, accidents, power line surges, neglect, improper installation, operation or maintenance, servicing of the Product conducted by anyone other than an authorized Red Sea service center, or failure to use or assemble the Product in accordance with any instructions provided (in the Product manual or otherwise) or the technical and/or safety standards of the country in which the Product is used. Additionally, any modification of the Product other than by an authorized Red Sea service center will invalidate this warranty.

In order to affect this warranty, please contact your local service center. For your convenience, details of authorized service centers can be found on Red Sea’s website. Proof of purchase will be required before warranty performance is rendered.

The sole and exclusive remedy against Red Sea shall be for the repair or replacement of the Product as provided above. NO OTHER REMEDY (including but not limited to, incidental or consequential damages for lost profits, lost sales, or any other incidental or consequential loss) shall be available. Some jurisdictions do not allow the exclusion of incidental or consequential damage, so the above limitation may not apply to you. To the full extent allowed by applicable law, in no event shall Red Sea be liable for any loss or damage to aquatic life, and/or damage to other property and/or individuals resulting from the use of the Product or arising out of any breach of this warranty. All implied warranties are excluded to the full extent allowed by applicable law, and to the extent that they may not be excluded, are limited to the applicable warranty period set forth above. Some jurisdictions do not allow limitations on how long an implied warranty or condition lasts, so this limitation may not apply to you. The express warranties made in this warranty are exclusive and may not be altered, enlarged, or changed by any distributor, dealer, or other person, whatsoever.

USA

Some states do not allow the exclusion or limitation of incidental or consequential damages, or limitations on how long an implied warranty lasts, so the above exclusion or limitations may not apply.

European Union – Disposal Information:

This symbol means that, according to local laws and regulations, your product should be disposed of separately from household waste. When this product reaches its end of life, take it to a collection point designated by local authorities. Some collection points accept products for free. The separate collection and recycling of your product at the time of disposal will help conserve natural resources and ensure that it is recycled in a manner that protects human health and the environment.

CE Declaration of Conformity:

The equipment complies with the RF Exposure Requirement 2014/53/EU, Council Recommendation on the limitation of exposure of the general public to electromagnetic fields (0-300 GHz). This equipment meets the following conformance standards: EN 300 328, EN 301 489-17.



DISPOSAL: Do not dispose this product as unsorted municipal waste. Collection of such waste separately for special treatment is necessary. This product must not be disposed together with the domestic waste. This product must be disposed at an authorized place for recycling of electrical and electronic appliances. By collecting and recycling waste, you help save natural resources, and make sure the product is disposed in an environmentally friendly and healthy way.

Red Sea U.S.A

4687 World Houston Parkway
#200 Houston,
TX 77032, U.S.A
support.usa@redseafish.com

Red Sea Europe

655 Rue des Frères
Lumière 27130 Verneuil
d'Avre et d'Iton, France
support.fr@redseafish.com

UK & Ireland

Red Sea Aquatics (UK) Ltd

PO Box 1237
Cheddar, BS279AG
uk.info@redseafish.com

Germany & Austria

Red Sea Deutschland

Büro Deutschland
Prinzenallee 7 (Prinzenpark)
40549 Düsseldorf
support.de@redseafish.com

China

Red Sea Aquatics (GZ) Ltd

Block 2-4, No.168, West Yingbin
Road, Xinhua Industrial Park,
Huadu District, Guangzhou City,
China, Postal code 510812.
Tel: +86-020-6625 3828
info.china@redseafish.com

株式会社エムエムシー企画レッ ドシー事業部

〒174-0063
東京都板橋区前野町6-29-4
info@mmclanning.com